

6-1996

Bob Gaboual

LUX

15Yr?

Jim

20Yr?





SEARCHERS GEM AND MINERAL SOCIETY, INC.  
Established June 20, 1958

Mailing Address: P O Box 3492  
Anaheim, CA 92804

CLUB OFFICERS

President	Herb Beckman	778-1496
1st Vice President	Lola Tapia	776-9815
2nd Vice President	Ken Nelson	(310) 431-7382
Secretary	Marie Cole	639-7983
Treasurer	Bob Gabourel	670-6786
Federation Delegate	Marge Jordan	897-2407
Director	Dr Chris Madsen	535-2936

COMMITTEE CHAIRPERSONS

Historian	Jan Gillette	776-9467
Anaheim Arts Council	Margaret Neeley	535-2030
Arts Council Alternate	Mae Freedman	774-6665
1996 Show Chairman	Jim Williamson	995-9080
1996 Co-Show Chairman	Larry Richey	846-3573
Bulletin Editor	Marge Jordan	897-2407
Bulletin Editor Alternate	Audrey Nichols	533-4675
Bulletin Mailout	Janet Cole	639-9025
Membership	Milly Arvanites	838-1924
Public Lands	Elmer Parsons	870-5495
Refreshments/Hospitality	Betty Henderson	772-1996
Sunshine	Froma Reiter	879-3514
Sunshine Alternate	Doris Pelfrey	774-2754
Veterans Coordinator	Larry Richey	846-3573
Library (Monthly) Drawing	Bob Dixon	534-5063
Meeting Host		
Phone Committee	Doris Pelfrey	774-2754
Social Director	Beth Pelfrey	774-2754

AFFILIATIONS: California Federation of Mineralogical Societies  
American Federation of Mineralogical Societies

The Searchers Gem and Mineral Society, Inc. regular meetings are held on the second Tuesday of each month on the basement level of the Anaheim Memorial Hospital Medical Office Building, 1211 W. LaPalma Avenue, Anaheim, CA. Meetings begin at 7:30 PM. Visitors are always welcome.

Membership dues are accepted January thru September. Adult Members: \$10.00 each, and Junior Members (under age 17) \$2.00.

Field Trips are usually held on the second weekend of each month. These are announced monthly. Trip maps, added activities, time changes and other pertinent information will be published in the bulletin.

Board Meetings are held on the fourth Tuesday of each month January through October and the third Tuesday in November and December. The meetings are held in the basement level Boardroom of the Anaheim Memorial Hospital Medical Office Building at 7:30 PM.

WORKSHOPS: Workshops have been temporarily cancelled.

REQUIREMENT: Items for the Bulletin must be in the hands of the editor by the first (1st) Tuesday of each month. Please mail all items to: Marge Jordan, 12161 Bartlett Street, Garden Grove, CA 92645-1525.

## PRESIDENT'S MESSAGE

This message is being written in Primeville, OR, eleven days into the Searchers annual long range/extended field trip. So far we have camped in Lassen Creek, CA, Plush, Glass Buttes and Primeville, OR. We have collected obsidian, sunstones, petrified wood, limbcasts and moss agate. The weather has been clear, sunny and cold at higher elevations, and warm at lower elevations. All campsites and field trips have been in beautiful and productive areas. A few nights ago we had a potluck dinner and as usual with no special planning, ground rules, or coordination, everything clicked. Only one dish was duplicated, and there were no leftovers. I have often wondered how can this be? What would happen if everyone prepared the same dish? Somehow, at Searcher potlucks this never happens.

Another hallmark of Searchers field trips has been thorough advance planning by the field trip chairman and field trip leaders along with good communications all through the trip. An individual would be sorely pressed to plan and take an extended rockhounding trip as productive and efficient as our club outings. As an added bonus, the diverse personalities, educations and life experiences of the club members in combination with our common bond and shared interest in earth sciences make for an outstanding and memorable experience. I urge those club members who have not yet attended Searchers outings to do so as soon as you can. Many of these trips can be attended for one day if you do not have a tent or RV and the experience you will find to be very rewarding.

By now, Heritage Day at Oak Canyon Nature Center is history and I'm sure that the Searchers participation helped make this event an enjoyable one for the children who attended from Anaheim and neighboring cities. Thanks to all of you who helped out with this event.

As I've been vacationing since the last Searcher meeting, I can not report on the progress of the workshop planning committee except to tell you that the committee has been active in May, thanks to Jim Williamson who graciously agreed to chair the committee in my absence. I hope to be able to report on the committee's progress at the June general meeting.

Herb Beckman

FUTURE CLUB ACTIVITIES:

June 25th - Board Meeting

July 2nd - Bulletin Items due

July 9th - General Meeting

July 13th - Searcher BBQ/Picnic - Lee's Home - Lake Elsinore

SHOW DATES:

July 12 - 14 Arroyo Grande  
 Orcutt Mineral Society  
 Pow - Wow  
 Arroyo Grande High School - Parking Lot  
 495 Valley Road  
 Arroyo Grande, CA  
 Hours: Fri 9 - 5 Sat 9 - 5 Sun 9 - 4

July 13 - 14 Culver City Rock and Mineral Club  
 Veterans Memorial Aud  
 Overland & Culver  
 Culver City, CA  
 Hours: Sat 10 - 6 Sun 10 - 5



# DIAMOND DAZE

## 1996 AUGUST 6 - 11

California Federation of Mineralogical Societies  
 American Federation of Mineralogical Societies

# GEM AND MINERAL SHOW

Riverside Convention Center  
 3433 Orange St. Riverside, California

For Reservations, - Camping and Show Package Phone (918) 288-2896

60 years ago, rock and mineral clubs throughout California founded CFMS  
 at Riverside, California - Now we return to Celebrate

### EXHIBITS - DEMONSTRATIONS - SYMPOSIUMS

#### FEDERATION REPORT:

There will be a wide variety of activities at Diamond Daze to interest everyone. Following is a condensed Program of Events for those who are interested in attending some of the symposiums or other informative programs that are offered. I do have forms available for anyone interested in attending a symposium.

This will be our August field trip. Anyone interested in camping at Rancho Jurupa Park during that weekend please see the August field trip article elsewhere in this bulletin.

Marge Jordan  
 Federation Director

DIAMOND DAZE - PROGRAM OF EVENTSFriday - August 9th

9:00 AM Registration for Faceting Symposium - Lobby Conventen Center  
 9:45 AM Opening Ceremony (front) Convention Center  
 10:00 AM SHOW OPENS  
10:00 AM to 4:00 PM - Symposium - Petrified Wood at Holiday Inn  
 Symposium - Faceting in Community Room - Convention Center  
 Symposium - Carving - Mission Room - Convention Center  
 7:30 PM Symposium - Petrified Wood at Holiday Inn  
 6:00 PM SHOW CLOSES

Saturday - August 10th

9:00 AM Registration for Faceting Symposium  
 9:00 to Noon Symposium - Petrified Wood at Holiday Inn  
 10:00 AM SHOW OPENS  
 10:00 AM Symposium - Faceting - Community Room - Convention Center  
 10:00 AM Symposium - Opal - Mission Room - Convention Center  
 12:00 Noon Faceter Luncheon  
 3:00 PM Lecture - Metal Detector - Board Room - Convention Center  
 4:00 PM Metal Detector Fun Hunt on Fiesta Grounds - Convention Center (1 hour)  
 5:15 PM Auction  
 6:00 PM SHOW CLOSES

Sunday - August 11th

9:00 AM Faceting Symposium Registration  
 10:00 AM SHOW OPENS  
 10:00 AM Symposium - Faceting - Community Room - Convention Center (until 1:00PM)  
 10:00 AM Symposium - Carving - Mission Room - Convention Center (until 1:00PM)  
 3:30 PM Raffle Winners announced  
 5:00 PM SHOW CLOSES

## DIAMOND DAZE SYMPOSIUMS

## CARVERS' SYMPOSIUM

Gem Carvers Guild of America  
 Mission Inn Room - Convention Center

Friday - Aug 9th 10:00 AM to 4:00 PM

Sunday - Aug 11th 10:00 AM to 1:00 PM

Tips on Carving Labradorite - Harriette Breitman  
 The Making of Cameos - Sylvia Cliffe  
 Carnelian, Specialty Tools & Finishing Tips - Fred Day, New Zealand  
 Art Related to Carving - Ruth Forrest  
 Carving Related to Art - Vince Jarrell  
 Sculpture in Stone - Virgil Keltz, Washington  
 Howlite Bas-relief - Virginia Pace  
 Latest Tips of Safety - William Piworski  
 Tips on Carving Tools - DeWayne Sharp, San Jose  
 Carving Dinosaur Bone into Dinosaurs - Lance Tanner, British Columbia

## DIAMOND DAZE SYMPOSIUMS (CONT'D)

OPAL SYMPOSIUM

American Opal Society

Mission Inn Room - Convention Center

Saturday, Aug 10th

9:30 AM Welcome and Introduction - Dr Jay Carey  
 9:40 AM Opal Mining - Barbara McCondra  
 10:35 AM Cutting and Polish Opal - Dr Paul Downing  
 11:35 AM Opal Jewelry - Walt Johnson  
 12:30 PM Lunch break  
 1:30 PM Opal Appraisal - Dr Paul Downing  
 2:30 PM Opalized Fossils - David Burton  
 3:30 PM (Topic to be announced) - Tim Thomas

PETRIFIED WOOD SYMPOSIUM

North Orange County G.M.S.

Embassy Room - Holiday Inn

Instructor: W. Walton WrightThursday, Aug 8th

7:30 PM Introduction to Petrified Wood Identification

Friday, Aug 9th

9:00 AM Ferns and Conifers  
 1:30 PM Continued  
 7:30 PM Dicots

Saturday, Aug 10th

9:00 AM General Identification of Wood

FACETERS' SYMPOSIUM

Faceters' Guild of Southern California

Community Room - Convention Center

Friday, Aug 9th

10:00 AM Welcome and Introduction - Glenn Klein  
 10:10 AM Faceting Techniques for Soft Stones - Art Grant  
 11:00 AM (Topic to be Announced) - Dennis Anderson  
 12:00 Noon LUNCH BREAK  
 1:30 PM The Highlights of New Facet Designs - Norm Steele  
 2:30 PM Methods & Techniques of Cutting & Polishing Large Gemstones - Ed Romak  
 3:30 PM Crystal Structure and What its Implications are for Faceters -  
 6:00 PM to 7:00 PM Hospitality Hour - Holiday Inn, Rm 410 John Sinkankas  
 Sponsored by Ultra-Tec and Jarvi Tool

Saturday, Aug 10th

10:00 AM The Polishing of Faceted Gems - Glenn and Martha Vargas  
 10:45 AM Cutting Unique Synthetic Stones - Art Grant  
 12:00 to 1:30 PM - Awards Luncheon in Symposium Room - Bob Haines  
 Symposium Competition Awards Ceremony Trophies presented  
 2:00 PM (Topic to be announced) - Jerry Carroll  
 3:00 PM One Hundred and One Tips for First Year Faceters - Carl Unruh  
 4:00 PM (Topic to be announced) - Bob Kleppe

Sunday, Aug 11th

1:30 PM Panel Discussion. Your questions and our speakers answers  
 will make an interesting ending to the Symposium  
 3:00 PM The symposium ends. Closing - Glenn Klien

HIGHLIGHTS - MAY GENERAL MEETING:

The post show meeting is to be held on May 15th. Committee Chairpersons are asked to bring their inputs. All club members are welcome.

Some members will be working the Heritage Day event at Oak Canyon Nature Center on June 2nd and supplies will be needed. A motion was made by Jay Cole and seconded by Janet Cole that the budget of \$100 to purchase these supplies should be increased to \$125. Motion passed.

Elmer Parsons gave a summary of three articles concerning public lands. He said that HR 2943 (The Fossil Act) currently in the house should have our attention and suggested that we should write letters on our feelings on this matter. He also made mention of "National Geographic" article "California Desert Lands - A Tribute to Sublime Desolation". Should you need further information contact Elmer.

A motion was made by Lola Tapia and seconded by Tony Tapia to let the Workshop Committee decide on a suitable organization to share the cost and use of a workshop. Motion passed.

Workshop Committee members are: Herb Beckman, Ken Despain, Bob Dixon, George Lux, Lola Tapia, Paul Wesley, Jim Williamson and Connie Van Kampen.

Our program for the evening was presented by Larry Richey who gave a very good program on "Carving Fireagate." Also, Marvin Mog held a Silent Auction and many members got some very good items.

Marie Cole  
Secretary

HERITAGE DAY - 1996:

The 15th Annual Heritage Day Celebration was held June 2nd at Oak Canyon Nature Center. The event was co-sponsored by the Anaheim Parks and Recreation and the Canyon Hills Junior Women's Club. The focus of the day was on demonstrating arts and crafts of early California. Children were involved in such things as weaving, clay pots, bead work, cross cut sawing, nail pounding and ring making. Demonstrations included face painting, Native American Dancers, Quilters, Bee Keeping and more. The Searchers were fully occupied with making rings, however, we did find time to check out a few of the day's events.

The Searchers committed their support to this project to take advantage of the opportunity to educate the public concerning the earth sciences. The support started with a donation of \$125 for materials to build the rings and approximately 44 hours of member's time. The children (470) who passed by our booth received a free ring of their design and an opportunity to compare Petrified Wood to Fossilized Whale Bone to Jade, Agate and Obsidian. They (and their parents) were also provided information about the Searchers Gem and Mineral Society. The day was a busy one, where fun was had by all!!

A special thanks to Ken Despain, Harry and Betty Nelson, Larry Richey, Tom Talip, Connie Van Kampen and Stacy Williamson who donated time and/or material to make the day a great success.

A special thanks is also sent out to the Canyon Hills Junior Women's Club for providing the Searchers this opportunity to participate in their Heritage Day Celebration. They are to be congratulated for a fine job of orchestrating a problem free event! When we arrived our tables and chairs were in place and we were provided coffee, donuts and bagels. Each of the Searchers was also treated to a free lunch, and, as if that was not enough, to show their appreciation, the Canyon Hills Junior Women's Club presented a donation of \$100 to the Searchers.

Jim Williamson

PROGRAM REPORT:

Our May program was presented by Larry Richey who gave a very informative program on "Carving of Fireagate". Larry named several areas where one could hunt for fireagate and how to grind, polish and how to work fireagate in order to obtain a piece that you can be proud of.

This evening, in addition to our Annual Potluck we will have presentation of Awards and Trophies to members who exhibited their cases in our 1996 Show.

Our July program has not been confirmed but possibly we will have a video taken during our 1996 show.

Lola Tapia

REFRESHMENTS:

Mae Freedman and Milly Arvanites will be setting up and coordinating the Potluck this evening. Thanks ladies!

July refreshments will be served by Bobbie Madsen and August, Alice Lux. Elena Goldgorin has volunteered for September. Marie Cole and Jan Gillette for October. I will be doing "pie night" for the November meeting but I will need some volunteers to help cut and serve pie. Thanks.

Betty Henderson

MEMBERSHIP:

Please welcome new members: Tom and Sherri Bond  
6940 Knott Avenue No. "E"  
Buena Park, CA 90621 (714) 521-6867

This brings our membership to 132.

Milly Arvanites

SLABS FOR VET'S:

Remember we can always use more slabs for the Veteran's Lapidary Shop. If you have old slabs you're not using, or you're running that saw -- cut one for the Vet's.

I will have a box available at all of our General Meetings - back by the coffee. Just drop them in the box marked "Searchers Slabs for Vet's".

Larry Richey

SHARING AND CARING:

Have not heard of any illness of members so hopefully everyone is doing well. Let's keep it that way.

Many of you will remember Evelyn Swanson. Sorry to report that she is now residing at Chapman Manor. Joel informed us during the show that she is doing well considering her illness. Said she really enjoys mail so if anyone would like to send cards her address is:

Mrs Evelyn Swanson  
c/o Chapman Manor  
512 N. Chapman Avenue  
Fullerton, CA 92633

Froma





1996 POST SHOW COMMITTEE MEETING:

As you are aware a post show committee meeting was held on Thursday, May 16th. The purpose of that meeting was to identify opportunities to improve next year's show. The meeting was well attended and proved to be very productive.

It was refreshing to see such a nice mix of seasoned and new members participating to achieve the goal of identifying opportunities for improvement. At the first show committee meeting in January the committee was asked to make notes of problems and/or significant events to be considered at the post show meeting. The response was great. We were unable to work through the agenda in one session. The meeting time was limited to 9:30 PM and another meeting will be scheduled in the very near future to complete this effort.

The committee members were asked to seek comments and suggestions from the membership so all input can be considered. If ANYONE has an idea to be considered please pass that idea to a committee member. The committee will develop recommendations and present them to the Board for approval. I will set a meeting date and mail notices to each committee member as soon as possible.

Jim Williamson  
1996 Show Chairman

A BIG THANKS!

We would like to thank all the Searchers who worked so hard helping in the kitchen during the show. This includes those who donated baked goods, those who stood long hours at the serving counter, our faithful cashier and those who relieved her, and the gang who braved tight quarters in the hot kitchen.

Most of all we want to thank those very special Searchers who saw the need and worked not only their shifts but continued on and came back again and again to help us out. We appreciate you all.

Harry and Betty Nelson  
Jay Cole

CHILDREN'S JEWELRY - 1996 SHOW:

Thank you all for your help with this project. The eyes of the kids tell us the story. How proud our kids are with what we made!

I would like to thank Mae Freedman and Ken Despain and all of you who made donations of rock or findings so that we can continue having the Children's Jewelry Booth. I would also like to thank all my help. Special thanks to John Figueroa and Carol McCluney and Karen Martinez for getting involved. Thanks to Elmer Parsons for the use of his big tarp for our shade and comfort outside. A very special thanks to Tom Talip for all his long hours of help both days. Tom's hard work saved me...I couldn't have done it with his support. Again, thank you all.

Larry Richey

FOR SALE:

MOTORHOME FOR SALE - 1978 Midas - Class "C" - Ford 460  
Dash and Roof Air - 4 K Onan Generator - Good Tires -  
New Catalitic and Water Heater - Drive Train Good  
Asking \$4,800 - Jeanne Aasen (619) 365-9512

SEPTEMBER BEACH GET TOGETHER - SEP 14th and 15th:"

This September get together will be held at Bolsa Chica State Beach which is between the "cliffs" at Huntington Beach and Sunset Beach.

One Section is for overnight camping. The cost is \$14.00 per night (\$12.00 for Seniors). Reservations should be made now by calling 1-800-444-7275. One person can make reservations for two sites only. Mary and I as well as the Everitts and some others will arrive Friday and stay thru Sunday night.

Those wishing to come out for the day may park in a day parking area adjacent to the camping area. The cost is \$5.00 per vehicle (\$4.00 for Seniors).

Ken Nelson

Map - DIAMOND DAZE SHOW

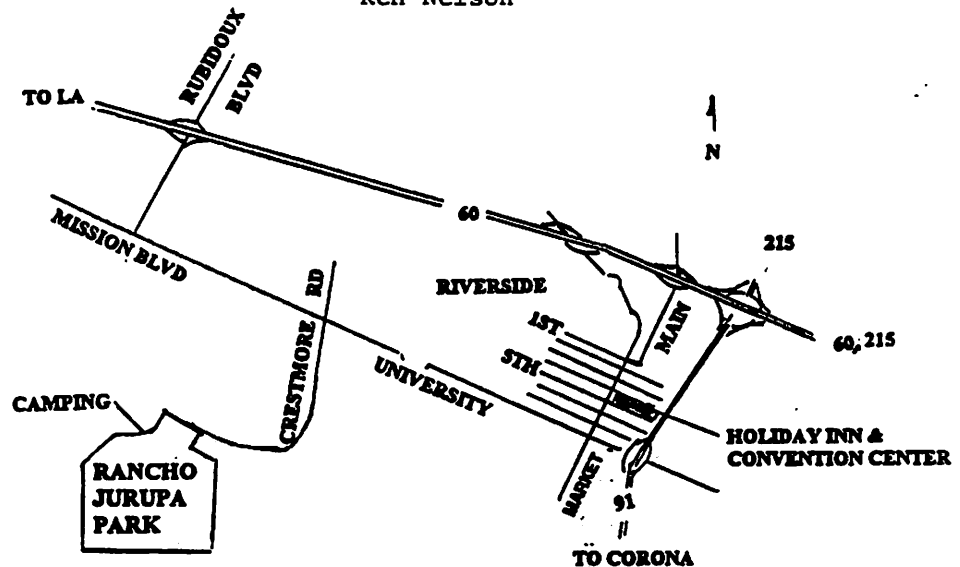
TROPHIES and RIBBONS FOR SHOW EXHIBITORS:

The following members displayed their cases at our 1996 Show:

Herb Beckman	George Mitchum	Merle and Jeanne Howe
Jim and Joan Everitt	Marge Jordan	Wes Miller
Grant Miller	Conrad Cone (2)	Walter Mroch
Jay and Marie Cole	Ed Zinn	Steve Knox
Lowell Disney	Hal Pelfrey	Allen Silverstein (2)
Elizabeth and Chris Madsen	Larry Richey	Tony and Lola Tapia
Wes Greenamyer	Tom Talip	Jim Williamson
Ken Landers	Betty and Harry Nelson	

Congratulations to Floyd and Margaret Neeley for the 20th Consecutive Year Exhibitor Award and to Connie Van Kampen for her 15th Year Exhibitor Award.

Ken Despain

COWBOY POETRY:

One of the entertainments provided at Rockmania, the Lordsburg, New Mexico gem and mineral show held in February of this year was an evening of Cowboy Poetry. One of the poets showcased at this event was Bill Cavalier, of Animas, New Mexico, who delighted everyone with his original poem about rockhounds. I thought the Searchers would enjoy it, so I wrote to Bill and asked for his permission to publish his poem in the Bulletin. He very graciously consented.

I hope you will enjoy it as much as we at the event did. Please note the poem is copyrighted, and no use other than this publication can be made of it without his Express Written Consent. Poem - next page.

ROCKHOUNDS

They wander 'round in gale-force winds,  
and 'neath the desert sun.  
Through bitter cold, or so I'm told,  
because, they say, it's fun.

They pick their way past rattlesnakes,  
and over cactus plants.  
They risk their neck, but on they trek,  
with bites from bees and ants.

They climb their way up mountaintops,  
and into canyons deep.  
To search the ground, where rocks abound,  
for specimens to keep.

Sometimes they climb down riverbanks  
to wade in waters cold.  
To rinse the sand, with trusty pan,  
in search of flakes of gold.

Now, some folks make their pilgrimage  
to Mecca, I recall.  
Some go in hope, to see the Pope.  
For Jews, the Wailing Wall.

But rockhound folk don't go abroad  
to find their place to pray.  
To pay respect, the place they trek  
is Quartzite, so they say.

They stop in every rockshop.  
That's a bet that will not fail.  
Then gather mounds, of ninety pounds,  
in boxes, trunks, and pails.

And oh, to hear the things they say:  
"That azurite's too pale."  
"That opal there, just won't compare."  
"The rhyolite's on sale!"

"This turquoise comes from Bisbee,  
but Hachita's is the best."  
And on they talk (or more like squalk)  
like lunatics obsessed.

He searches through a dusty box.  
He can't believe his eyes!  
"Why, look here Marge, this piece so large!  
My God, it's agatized!

I must confess that I can't tell you  
flint from trinitite  
Why, once I asked a rockhound friend  
if he had kryptonite.

But let's not pity rockhounds, friends.  
To each his own, I guess.  
I'll tell you first, that they are cursed,  
and rocks are their obsess.

And if you took his rocks away,  
would surely cause him harm.  
So quite abrupt, they'd lock him up.  
inside the funny farm!

By Bill Cavaliere  
Jan. 30, 1996

Copyright © 1996  
All rights reserved. No part of this may be  
reproduced or copied without permission of  
the author.

Bill Cavaliere  
P O Box 102,  
Animas, NM 88020  
(505) 436-2371

LONG RANGE FIELD TRIP - UPDATE (June 1st):

Searcher rigs started arriving at the Lassen Creek Campground on Friday, May 24th. By Monday we had ten rigs camping and one moteling. The campground was just outstanding; a green meadow with tall pines and a creek running through it. We dug obsidian in three locations, the most prolific was for rainbow. We also collected needles as well as "seal skin", gray banded and plume.

Saturday night we had "happy hour" and Sunday night we all had dinner at a basque restaurant in Alturas and stuffed ourselves. Most of the crowd got lamb chops, lamb steak or rib eye steak. The portions are enormous. Even with the Searchers appetites several doggie bags left the restaurant. Monday night we celebrated Jim Provance's birthday at camp.

Tuesday on through Lakeview, CA to Plush, OR and the sunstones area for three nights. The view was now mesquite bushes and dirt. By the end of two and a half days of digging Jim Everitt had the best collection of reddish stones and Floyd had the largest champagne colored. Marv had the prettiest individual stone.

Friday, May 31st it was on to Obsidian Buttes, OR. One rig left us so we're down to 10 rigs. As of the end of Saturday, June 1st, everyone had all they wanted of gold sheen, gray banded, flame and midnight lace. There is so much obsidian that it is difficult to decide what to take. That evening we relaxed and had one of those Searcher potlucks. I ate so much that I never made it to dessert.

In summary, the weather has been great and everyone is having a good time so on to Primeville, OR.

Ken Nelson



JULY FIELD TRIP - JULY 13th - BBQ/PICNIC:

Mike and Michele Lee have graciously agreed to host a BBQ/Picnic on Saturday, July 13th, at their home in Elsinore. This will be a BBQ/Picnic - potluck. Please bring a dish to share and whatever you want to BBQ, steak, hamburgers, weiners, etc. Also please bring folding chairs and a small table. The time will be 4:00 PM and we'll BBQ a little later. By 4:00 PM the weather should start to cool down some. Please see map elsewhere in this bulletin.

Ken

AUGUST FIELD TRIP - AUGUST 10th and 11th):

The AFMS/CFMS "Diamond Daze" Gem and Mineral Show is being held in Riverside, CA. The weekend of the 10th and 11th will be our Field Trip. Camping for those who take their RVs will be at the Rancho Jurupa Park. There are full hook-ups and the cost I believe is \$16. There will be transportation available from Jurupa Park to the Show at the Convention Center. Reservations may be made at Rancho Jurupa by calling 1-800-234-PARK. See map elsewhere in this bulletin, see page 8.

Ken

BULLETIN ITEMS DUE TO EDITOR NOT LATER THAN 2 JULY 1996.

B B Q / PICNIC

SATURDAY - JULY 13TH - 4:00 PM

WHERE: MIKE AND MICHELE LEE'S HOME  
 18062 KIMBERLY SUE CT  
 LAKE ELSINORE (909) 674-7223

BRING: YOUR OWN MEAT TO B B Q AND A SIDE DISH  
 TO SHARE

BEVERAGES: BEER/SOFTDRINKS/ICE TEA PROVIDED

PLEASE BRING FOLDING CHAIRS AND IF YOU'D LIKE  
 A SMALL FOLDING TABLE.

**\*\* JULY FANTASY FIELD TRIP \*\***

ADVENTUROUS SEARCHERS MAY WANT TO COME EARLY  
 AND HUNT FOR EXCITING SPECIMENS LOCATED DEEP IN  
 THE CREVICES OF THE LAKE ELSINORE OUTLET CENTER.  
 THE OUTLET STORES ARE JUST ONE EXIT BEFORE (NORTH  
 OF) THE EXIT TO THE LEE'S HOUSE.

SHOP'TIL YOU DROP, THEN DRAG YOURSELVES TO  
 THE PICNIC FOR REFRESHMENTS AND REFILLS OF FUN!

(BRING YOUR BATHING SUIT AND TOWELL TOO)



MIKE + MICHELE LEE  
 18062 KIMBERLY SUE CT.  
 LAKE ELSINORE  
 (909) 674-7223

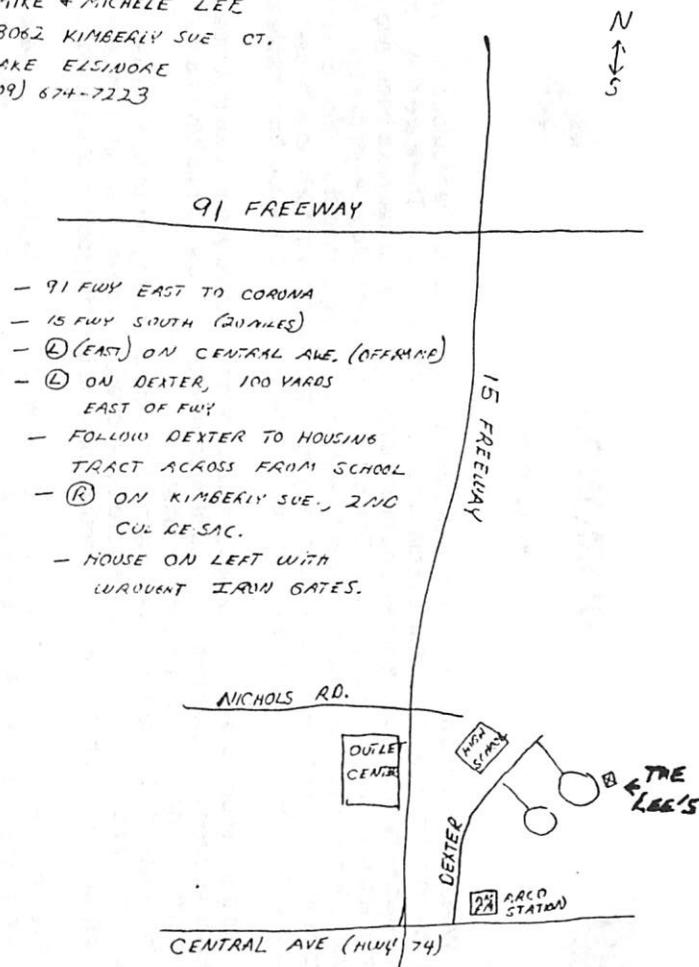

Searchers Gem and Mineral Society assumes no  
 responsibility for injuries or property damage  
 due to accidents, carelessness or Acts of God.  
 Searchers and their guests assume all risks  
 during club activities.



## DIAMONDS

by Gene LaBerge



When we think of diamonds, most of us think of South Africa, for the fabulous mines of that country have been the major source of diamonds for nearly a century. There are many stories about the discovery of the various mines, and of the amazing diamonds that have been recovered during the history of mining in South Africa. One of the more memorable experiences of my life was a visit to the Premier Mine at Kimberly, South Africa, as a young geologist in 1964. Even more memorable was the visit my wife and I made during that trip to Kimberly in 1964, to a "house" where diamonds were sorted and graded. I'm not sure that a visit like that would be possible any more.

But the diamond scene has changed dramatically in the last 20 years. Vast quantities of diamonds have been recovered from the Yakutsk area in Siberia. These stones have had an important influence on the world's diamond market.

In the late 1970's, diamonds were discovered in the desert regions of northwestern Australia. Interestingly, the diamond-bearing area of Australia has been called "the Kimberlies" for nearly a century! The Kimberly region of Australia is now the leading producer of diamonds in the world.

Even more recently, a diamond rush in the Northwest Territories of Canada has become the greatest mineral rush ever in North America. Rumors of amazingly rich diamond pipes provide fuel for the stories of this new diamond district.

And diamond exploration has been ongoing for nearly 15 years in the Great Lakes region. Diamonds up to 20 carats in weight, were discovered in the glacial drift in Wisconsin over a century ago. The source of these diamonds has remained a mystery. However, the discovery of Kimberlites in Northern Michigan between Crystal Falls and Escanaba has certainly focused the search!

Kimberlites are very difficult to find because they are very small features. They form as small, very explosive, circular "pipe-like" volcanic necks only a few hundred feet across. The rock in Kimberlites originates in the earth's mantle, perhaps a hundred miles deep. The rock, including the diamonds, is carried to the earth's surface by gases escaping from the mantle. As the material approaches the surface, expansion of the gas causes intense brecciation of the crustal rocks as well as the Kimberlite itself. One of the most characteristic features of Kimberlites is the mixture of a wide variety of rock types, mostly in fragments less than one inch in diameter.

Kimberlites also contain some very distinctive minerals. Pinkish red pyrope garnets and emerald green chrome diopside along with lustrous black metallic crystals of ilmenite and brassy yellow books of phlogopite mica, are sprinkled throughout the dark greenish black matrix that is often very altered to serpentine. Most Kimberlites are geologically very "young". In South Africa, Australia, Siberia and Michigan, they appear to be Cretaceous in age. The Kimberlites in the Northwest Territories of Canada even contain wood fragments!!

Again, I remember our experience in South Africa, where the diamonds were separated from the host Kimberlite. The process evidently resulted in the separation of various mineral concentrates, for I recall walking on a path whose surface was red pyrope garnets, and another path surfaced with emerald green chrome diopside. Those brilliant paths leading to the diamond sorting house were at least as exciting as the "yellow brick road" in the Wizard of Oz!!

The sorting house was another fascinating place. We were taken in through several sets of doors that had to be keyed simultaneously from both sides. The room was about 20 by 30 feet with windows on two sides. Long tables lined the walls with windows. A number of workers (mainly women) sorted the diamonds. Each worker had a mound of diamonds to sort and grade by color. The crystals in each pile were limited to a certain size range. One worker had a mound of diamonds all one-half inch or larger. The next worker had a pile of crystal about three-eighths to one-half inch in diameter, and so on, around the room. Because color is so important to the value of the diamonds, the workers made maximum use of the natural light from the windows. Needless to say our several hours in the sorting house went by very quickly! I could write on for pages, but I will end this article by saying that diamonds, and the rocks in which they form possess many fascinating features.